

# terrier belmont

The new Terrier Belmont  
Thermostatic Radiator Valve range



# Manual Radiator Valves

The new manual radiator valve range offering both traditional handwheel and lockshield styles, along with a new concealed lockshield style in both angled and straight patterns.

A 'no drain solution', on manual valves allows the O ring seal to be changed with the system still full of water, by using a gland removal tool. This development minimises down time while saving both cost and time on site.

Innovations introduced for the first time include a concealed lockshield cap on the manual radiator valve, which requires an allen key to adjust the flow. Offering this as a standard feature and not an optional extra is a first in the industry.



## Specification

- Suits a wide range of commercial applications
- Valves can be serviced without draining the system
- Approved to BS2767-10
- Concealed lockshield with allen key adjustment
- Flow chart information available on request

## Product range – 1/2"

680001	1/2"/15mm 97WH Belmont Angle Radiator Valve
680002	1/2"/15mm 97LS Belmont Angle Radiator Valve
680007	1/2"/15mm 97WH CP Belmont Angle Radiator Valve
680008	1/2"/15mm 97LS CP Belmont Angle Radiator Valve
680009	1/2"/15mm 97DLS CP Belmont Angle Radiator Valve
681001	1/2"/15mm 98WH Belmont Straight Radiator Valve
681002	1/2"/15mm 98LS Belmont Straight Radiator Valve
681007	1/2"/15mm 98WH CP Belmont Straight Radiator Valve
681008	1/2"/15mm 98LS CP Belmont Straight Radiator Valve
686050	1/2"/15mm x 1/2" LS 351/3 Tamper Proof Angle
686052	1/2"/15mm x 1/2" LS 352/3 Tamper Proof Straight

## Product range – 3/4"\*

680004	3/4"/22mm 97WH Belmont Angle Radiator Valve
680005	3/4"/22mm 97LS Belmont Angle Radiator Valve
680010	3/4"/22mm 97WH CP Belmont Angle Radiator Valve
680011	3/4"/22mm 97LS CP Belmont Angle Radiator Valve
681004	3/4"/22mm 98WH Belmont Straight Radiator Valve
681005	3/4"/22mm 98LS Belmont Straight Radiator Valve
681010	3/4"/22mm 98WH CP Belmont Straight Radiator Valve
681011	3/4"/22mm 98LS CP Belmont Straight Radiator Valve
686051	3/4"/22mm x 3/4" LS351/3 Tamper Proof Angle
686053	3/4"/22mm x 3/4" LS 352/3 Tamper Proof Straight

## Product range – 1"\*

680013	1" x 1" 97WH Brass Angle Pattern
680014	1" x 1" 97LS Brass Angle Pattern
680015	1" x 1" 97CP WH Chrome Plated Angle Pattern
680016	1" x 1" 97CP LS Chrome Plated Angle Pattern

# Dimensions

## Belmont Wheel Head Angle Valve

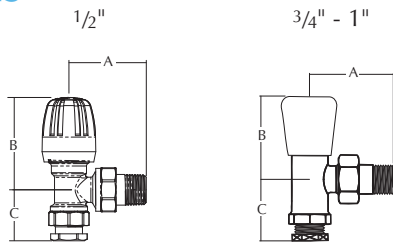

Size	A	B	C	Code
1/2"/15mm x 1/2"	53	63	35	680001
1/2"/15mm x 1/2" CP	53	63	35	680007
3/4"/22mm x 3/4"	63	56	56	680004
3/4"/22mm x 3/4" CP	63	56	56	680010
1" x 1"	73	70	73	680013
1" x 1" CP	73	70	73	680015

## Belmont Lock Shield Angle Valve

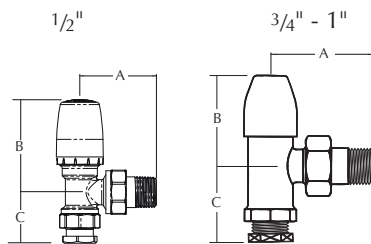

Size	A	B	C	Code
1/2"/15mm x 1/2"	52	63	35	680002
1/2"/15mm x 1/2" CP	52	63	35	680008
3/4"/22mm x 3/4"	63	56	53	680005
3/4"/22mm x 3/4" CP	63	56	53	680011
1" x 1"	73	70	37	680014
1" x 1" CP	73	70	37	680016

## Belmont Lock Shield Straight Valve

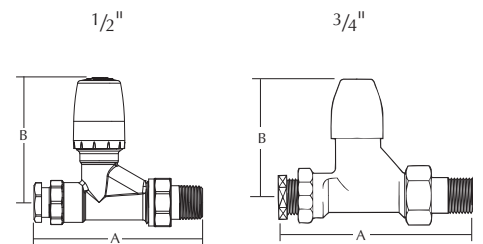

Size	A	B	Code
1/2"/15mm x 1/2"	105	78	681002
1/2"/15mm x 1/2" CP	105	78	681008
3/4"/22mm x 3/4"	134	77	681005
3/4"/22mm x 3/4" CP	134	77	681011

## Belmont Drainoff Lock Shield Angle Valve

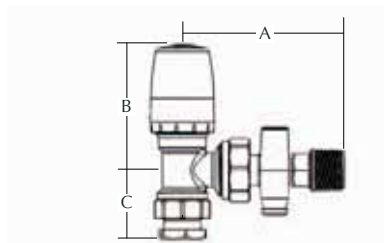

Size	A	B	C	Code
1/2"/15mm x 1/2" CP	81	63	35	680009

## Belmont Lock Shield Concealed Angle Valve

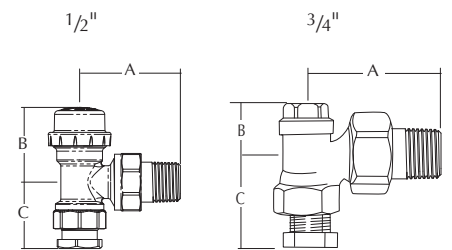

Size	A	B	C	Code
1/2"/15mm x 1/2"	53	39	35	686050
3/4"/22mm x 3/4"	67	40	69	681051

## Belmont Wheel Head Straight Valve

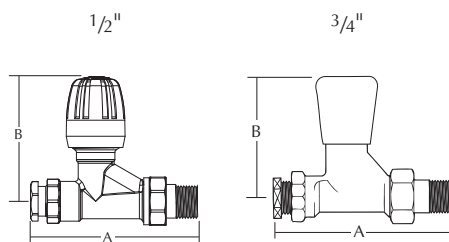

Size	A	B	Code
1/2"/15mm x 1/2"	105	78	681001
1/2"/15mm x 1/2" CP	105	78	681007
3/4"/22mm x 3/4"	134	80	681004
3/4"/22mm x 3/4" CP	134	80	681010

## Belmont Lock Shield Concealed Straight Valve

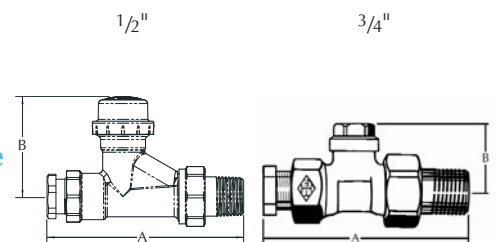

Size	A	B	Code
1/2"/15mm x 1/2"	105	54	686052
3/4"/22mm x 3/4"	105	30	681053

If the valve is to be used with iron you must deduct the nipple size from the dimensions provided. For 1/2" less 11mm and 3/4" less 12mm with 1" as per table.

# Thermostatic Radiator Valves

Belmont thermostatic radiator valves have been designed for use on residential through to commercial properties including Combi boiler installation.

The Belmont TRV benefits from a frost setting where the valve is opens automatically at 6°C to prevent the system freezing and a built in tamperproof feature that is key operated. The TRV also employs a 'lift and lock' operation which also prevents accidental adjustment.

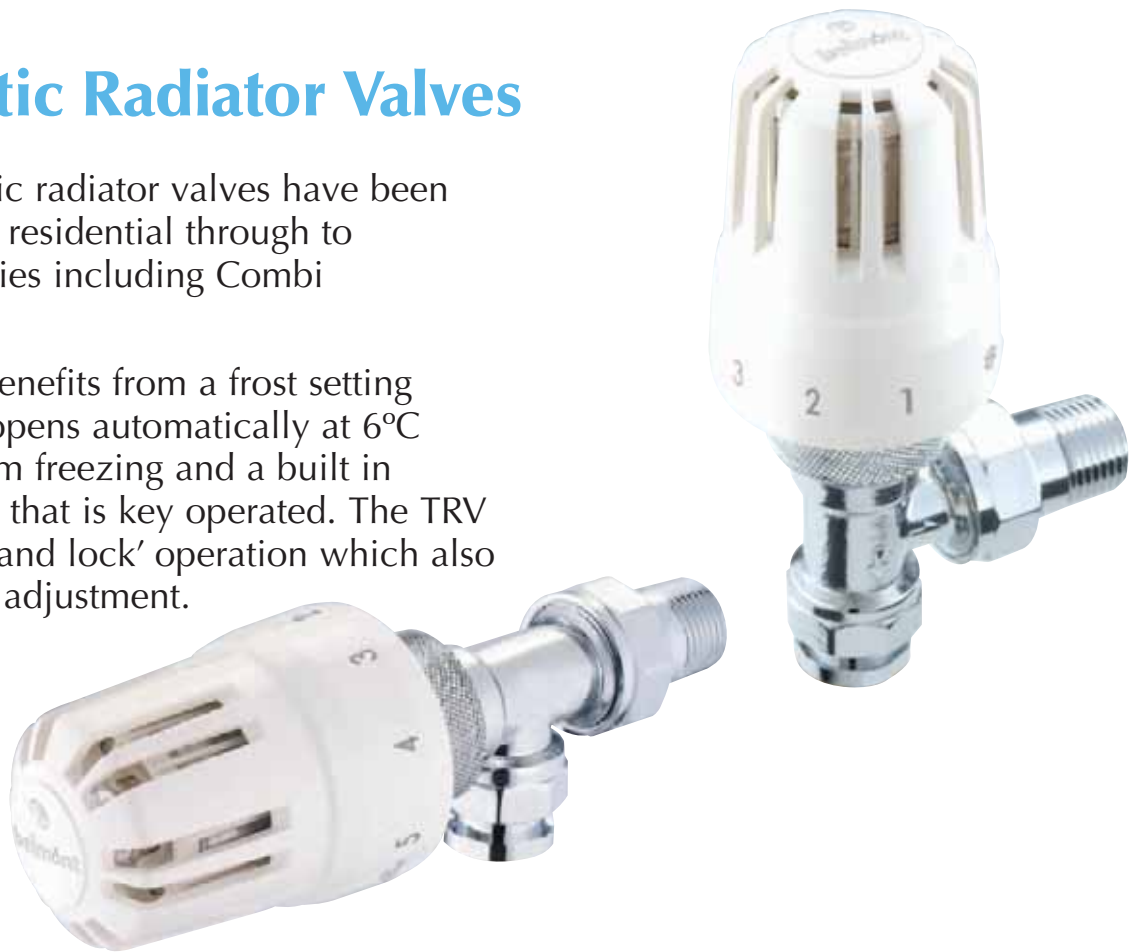

## Specification

- Control range of 11°C to 29°C
- Frost setting at 7°C
- Positive shut off for maintenance purposes
- Range limiting locking customise temperature setting
- Approved to EN215
- Suits copper and iron pipework
- Matching manual radiator valves
- 10 bar rating suitable for combi boilers
- Horizontal and vertical mounting
- Unique lift and lock tamper proof mechanism

## Product range

<b>686001</b>	1/2"/15mm x 1/2" B4451/3 Head Horizontal CP TRV Complete, White/Chrome
<b>686002</b>	1/2"/15mm x 1/2" B4452/3 Head Vertical CP TRV Complete, White/Chrome

## Dimensions

### 686001

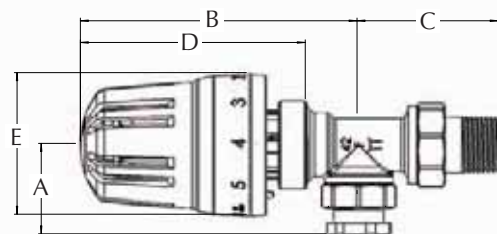

Size	A	B	C	D	E
1/2"/15mm x 1/2"	34	104	53	84	53

### 686002

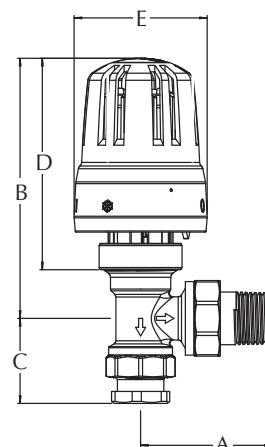

Size	A	B	C	D	E
1/2"/15mm x 1/2"	52	104	34	84	53

# Thermostatic Heads

Five different thermal heads are available, standard, remote sensing with 2m capillary and remote adjusting in 2m, 5m and 8m lengths. This makes the Belmont solution the first choice for those looking for the benefits of the latest products and service in a cost effective package



## Product range

<b>686005</b>	B1301-0/4 Thermostatic Head With 0 Position TRV, Thermal Head White
<b>686006</b>	B1401-0/4 TRV HD-2M Remote Sensor & 0 Position TRV Thermal, Head White
<b>686011</b>	B1701/4 Thermostatic Head CW Remote Adjustor & 0 Position, TRV Thermal Head, White
<b>686012</b>	B1701-5/4 Thermostatic Head CW 5M Remote Adjustor TRV Thermal Head, White
<b>686013</b>	B1701-8/4 Thermostatic Head CW 8M Remote Adjustor TRV Thermal Head, White



## Settings

A full list of thermal head temperature settings is provided below. All dimensions are in mm. C dimension for body type – refer to page 13. Maximum diameter of head 63mm

### 686005

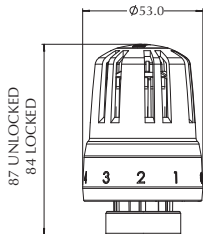

### 686006

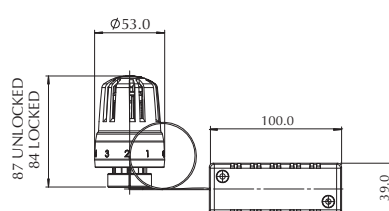

### 686011 (2m) 686012 (5m) 686013 (8m)

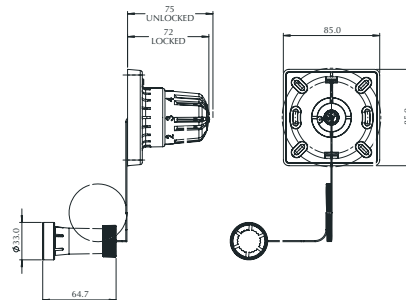

Deviations of a few degrees (K) are possible according to the mode of installation and design of the heating system. If the approximate temperature values specified in the above table cannot be reached please contact your heating specialist.

## Temperature setting range

0	*	1	2	3	4	5
Shut off	7°C	11–13°C	15–17°C	19–21°C	22–25°C	27–29°C

# Thermostatic Radiator Valve Bodies

The thermostatic radiator valves comprise three different body patterns angle, reverse angle (axial) and straight. They have a choice of pre-setting and non pre-setting options.

## Specification

- Approved to EN215
- Suits copper and iron pipework
- 10 bar rating suitable for combi boilers
- Horizontal and vertical mounting
- Insert removal and replacement without draining down when using special tool
- All valves are suitable for 2 pipe systems



## Product range (1/2"/15mm x 1/2")

686030	1/2"/15mm x 1/2" VB 1390/4 Angle Horizontal (Axial)
686032	1/2"/15mm x 1/2" VB 1290/4 Angle Horizontal
686034	1/2"/15mm x 1/2" VB 1490/4 Straight Valve Body
686080	1/2"/15mm x 1/2" VB 1390/4 Angle Horizontal Preset (Axial)
686082	1/2"/15mm x 1/2" VB 1290/4 Angle Horizontal Preset
686084	1/2"/15mm x 1/2" VB 1490/4 Straight Valve Body Preset

## Dimensions

### 686030, 686080

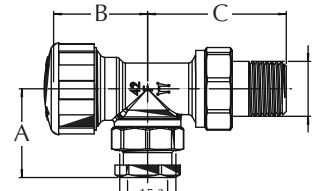

Size	Model	A	B	C
1/2"/15mm x 1/2"	VB 1390/3	34	36	53

### 686034, 686084

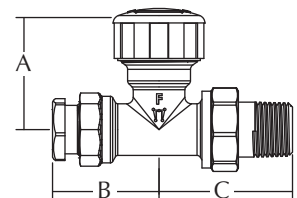

Size	Model	A	B	C
1/2"/15mm x 1/2"	VB 1490/3	43	41	51

### 686032, 686082

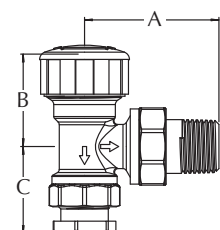

Size	Model	A	B	C
1/2"/15mm x 1/2"	VB 1290/3	53	36	34



The preset valves have a pre-setting mechanism that enables the user to adjust the maximum flow accurately. For flow charts on the preset valves please contact our technical department on 0870 1200285.

## Product range (3/4"/22mm x 3/4")

686031	3/4"/22mm x 3/4" VB 1390/4 Angle Horizontal (Axial)
686033	3/4"/22mm x 3/4" VB 1290/4 Angle Horizontal
686035	3/4"/22mm x 3/4" VB 1490/4 Straight Valve Body

686033

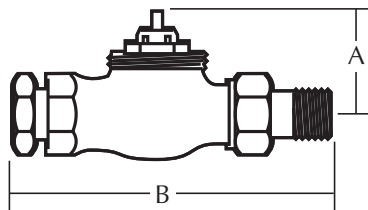

Size	Model	A	B	C
3/4"/22mm x 3/4"	VB 1490/3	42	91	-

686035

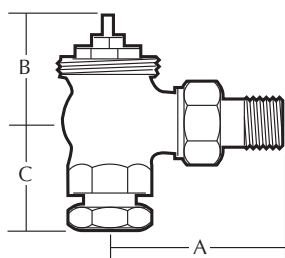

Size	Model	A	B	C
3/4"/22mm x 3/4"	VB 1290/3	66	68	26

**PLEASE NOTE:** The above 3/4" valve bodies are suitable for use with the following thermostatic heads.  
Thermostatic head for 3/4" VB use only.  
Robust head for 3/4" VB use only.

Please contact Sales Department for Order Codes

## Accessories

### Product range

686100	Gland Removal Tool
686101	Locking Limiting Pin
686102	Locking Limiting Pin
686104	Capillary Retaining Clips (SET)
686105	1/2" Iron Pipe Connection
686106	3/4" Iron Pipe Connection
686116	Thermal Head Tamperproof Key
686117	Remote Sensor Housing

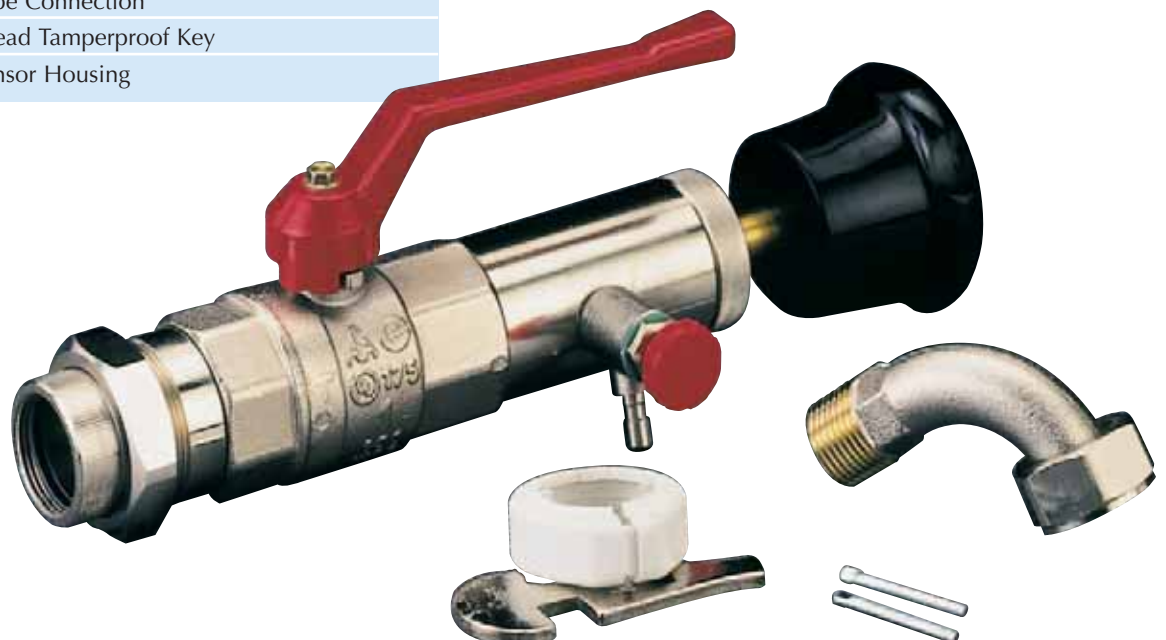



The perfect commercial partnership



**Pegler**

Pegler is an expert in the production of Taps, Mixers and Valve products. It boasts an unrivalled track record for integrity, quality, reliability and innovation.



LUXURY TAP SOLUTIONS



HEATING CONTROLS



VALVES AND FITTINGS



UTILITY TAP SOLUTIONS



**Yorkshire**

Yorkshire is a specialist in the production of metal plumbing and heating fittings. It has an established reputation for manufacturing quality products.



INTEGRAL SOLDER RING FITTINGS



THE PUSH-FIT JOINTING SYSTEM



THE PRESS-FIT JOINTING SYSTEM



COMPRESSION FITTINGS



END FEED FITTINGS



COMMERCIAL VALVES

terrier  
**belmont**

Thermostatic radiator valves

For further information, please contact your appropriate Sales Office

**UK**

Northern team:

Telephone: 0870 1200281 Fax: 01302 560108

Southern team:

Telephone: 0870 1200282 Fax: 01302 560458

Western team:

Telephone: 0870 1200283 Fax: 01302 560109

Eastern team:

Telephone: 0870 1200282 Fax: 01302 560458

**Email: [uk.sales@pegler.co.uk](mailto:uk.sales@pegler.co.uk)**

**EXPORT**

Telephone: +44 (0) 1302 855656

Fax: +44 (0) 1302 730513

**Email: [export@pegler.co.uk](mailto:export@pegler.co.uk)**

Technical helpline: 0870 1200285



**Pegler**

Pegler Limited, St. Catherine's Avenue, Doncaster, South Yorkshire, DN4 8DF, England.

**[www.pegler.yorkshire.co.uk](http://www.pegler.yorkshire.co.uk)**

Registered Company No. 01194543. Place of Registration: England

All brand names and logo styles are registered trademarks.

Maintaining a policy of continual product development, Pegler Ltd reserve the right to change specifications, design and materials of products listed in this leaflet without prior notice. LIT.REF: 880111.07.07